



LAND DEVELOPERS & BUILDERS

AN ISO 9001:2015 | AN ISO 45001:2018 | AN OHSAS 14001:2015 COMPANY

INNOVATIVE AND ATTRACTIVE PROJECT OF
PIYUSH LIFESPACES PVT. LTD, DHULE

JAAI



JAAI

ONGOING PROJECT

**LUXURIOUS APARTMENTS
1 AND 2 BHK FLATS**

Address- Plot No. 132, Jahind Colony,
Deopur Dhule.



JAAI

Project Registration Number www.mahrera.mahaonline.gov.in

P498000



Piyush LifeSpaces Pvt Ltd

Ground Floor, Sadafuli Apartments, Vidyawardhini Colony,
Sakri Road, Dhule, Maharashtra 424001

Think constructive!

CALL FOR ENQUIRY

 **94227 89770**

 **93254 29273**



LUXURIOUS APARTMENTS



LAND DEVELOPERS & BUILDERS
AN ISO 9001:2015 | AN ISO 40001:2015 | AN OHSAS 18001:2015 COMPANY

Think constructive!

Piyush LifeSpaces Pvt Ltd

Ground Floor, Sadafuli Apartments, Vidyawardhini Colony,
Sakri Road, Dhule, Maharashtra 424001

CALL FOR ENQUIRY

 **94227 89770 | 94223 05773**

JAAI

LUXURIOUS APARTMENTS

Address- Plot No. 132, Jahind Colony, Deopur Dhule.



JAAI

Project Registration Number

P498000

www.mahrera.mahaonline.gov.in

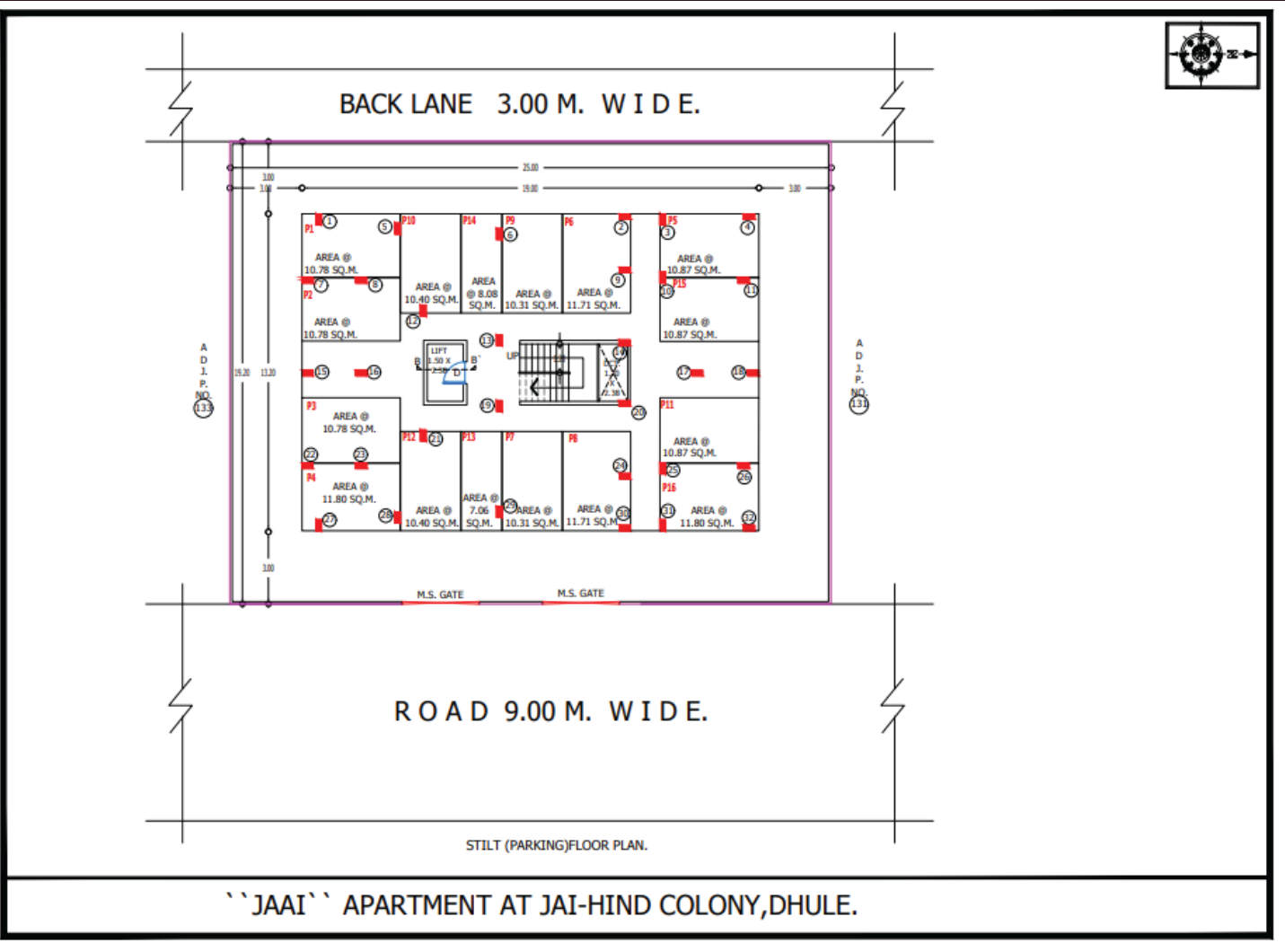

LAND DEVELOPERS & BUILDERS
AN ISO 9001:2015 | AN ISO 45001:2018 | AN OHSAS 18001:2015 COMPANY

Think constructive!

Piyush LifeSpaces Pvt Ltd

Ground Floor, Sadafuli Apartments, Vidyawardhini Colony,
Sakri Road, Dhule, Maharashtra 424001

CALL FOR ENQUIRY

 **94227 89770 | 94223 05773**

JAAI

LUXURIOUS APARTMENTS

Address- Plot No. 132, Jahind Colony, Deopur Dhule.



JAAI

Project Registration Number

P498000

www.mahra.mahaonline.gov.in



LAND DEVELOPERS & BUILDERS
AN ISO 9001:2015 | AN ISO 45001:2018 | AN OHSAS 18001:2015 COMPANY

Think constructive!

Piyush LifeSpaces Pvt Ltd

Ground Floor, Sadafuli Apartments, Vidyawardhini Colony,
Sakri Road, Dhule, Maharashtra 424001

CALL FOR ENQUIRY

 **94227 89770 | 94223 05773**

JAAI

LUXURIOUS APARTMENTS

Address- Plot No. 132, Jahind Colony, Deopur Dhule.



JAAI

Project Registration Number

P498000

www.mahera.mahaonline.gov.in

JAAI

TOP CLASS MODERN AMENITIES & SPECIFICATIONS

- RCC frame structure
- Brick masonry wall
- 2' * 2' Vitrified flooring
- Spacious parking
- Powder coated Aluminum section windows with glass & Mosquito SS Net
- MS Grill for windows & every window has a granite window seals
- Concealed Fireproof Electric wiring with MCB
- Cable for Cable TV, Inverter, CCTV & Telephone connections
- Provision of electric wiring for water purifier, refrigerator, exhaust and microwave oven
- Compound wall & Steel gate
- Overhead water tank for both purpose for storage water & fresh water
- Granite top kitchen otta with stainless steel sink
- Seven feet high Glazed Dado in bath & W.C
- Designer mixer Cocks in bathrooms
- Concealed water pipelines of standard PVC pipes & fittings
- Sewage drainage line with SW pipes/PVC pipes
- Wall putty plaster , Luster paint internally and ACE color exteriorly
- Adequate outdoor lighting for staircase and covered parking & in margin distances
- Proper waterproofing on WC & Bathrooms & on terraces
- Septic tank of adequate capacity
- Granite flooring for staircase
- Solar Water heater & its connections to required places
- Individual R O System for drinking water
- Granite frames for bathrooms & W.C
- Flush Doors with well finished laminated sheets
- Lift (Elevator)



LAND DEVELOPERS & BUILDERS
AN ISO 9001:2015 | AN ISO 4001:2018 | AN OHSAS 18001:2015 COMPANY

Think constructive!

Piyush LifeSpaces Pvt Ltd

Ground Floor, Sadafuli Apartments, Vidyawardhini Colony,
Sakri Road, Dhule, Maharashtra 424001

CALL FOR ENQUIRY

 **94227 89770 | 94223 05773**

JAAI

LUXURIOUS APARTMENTS

Address- Plot No. 132, Jahind Colony, Deopur Dhule.



JAAI

Project Registration Number

P498000

www.mahrera.mahaonline.gov.in

THANK YOU!



Piyush LifeSpaces Pvt Ltd

Ground Floor, Sadafuli Apartments, Vidyawardhini Colony,
Sakri Road, Dhule, Maharashtra 424001

Think constructive!

CALL FOR ENQUIRY



94227 89770



93254 29273